







Calle Cristobal

Landscape Maintenance District

June 8, 1997

- Legend**
-  New Zone Boundary
 -  Landscaped R/W
 -  Gutter Maintenance
 -  Decorative Median
 -  Landscaped Median
 -  Calle Cristobal District Boundary
 -  RUIS Base Map



Notes:

1. Each lot or parcel has been identified by the County Assessors Parcel Number and the Assessment Roll contained in the Engineers Report.
2. For a detailed description of the lines and dimensions of the lots or parcels shown on this Assessment Diagram, refer to the County Assessor's Maps, which shall govern with respect to all details concerning the lines and dimensions of such lots or parcels.

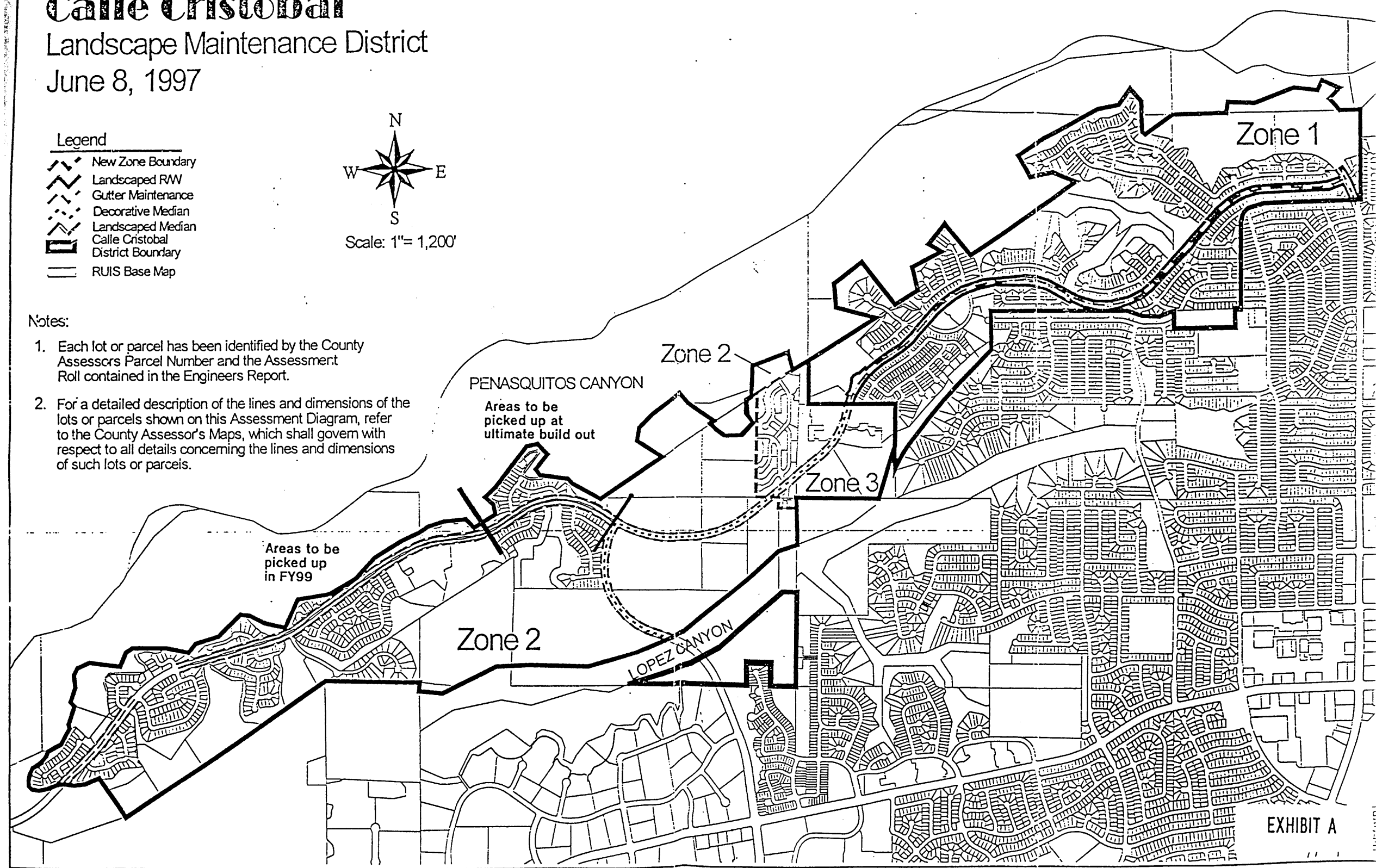

EXHIBIT A

CALLE CRISTOBAL

Maintenance Assessment District